



**BROWN'S HOTEL**  
LONDON  
A ROCCO FORTE HOTEL

At Brown's Hotel, you'll feel a strong sense of London. Mayfair – and the city's most celebrated galleries, restaurants, parks and shopping streets. Tradition, cut with a spirited English humour and cosmopolitan twist: playful touches, modern artworks and a fresh, unfussy ease among the wood panels, smart suits and afternoon teas. The glamour and gaiety the iconic address deserves, and the quality and charm the Forte name assures.

---

**Meetings & events facilities**

- 6 meeting rooms (4 interconnect) for receptions of up to 120 guests
- all with natural daylight, sash windows and high ceilings
- business centre
- valet parking available

---

**Accommodation**

- 82 bedrooms from 30m<sup>2</sup>
- 33 suites from 50m<sup>2</sup>

---

**Restaurants & bars**

- *Charlie's*
- *The Drawing Room*
- *The Donovan Bar*

---

**The Spa at Brown's**

- 3 treatment rooms (incl. a double suite)
- 24-hour gym

---

**Transfers**

- 30 min drive from London City Airport
- 45 min drive from London Heathrow Airport
- 70 min drive from London Gatwick Airport
- 10 min drive from Euston and Victoria Stations
- 15 min drive from St Pancras International and King's Cross Station

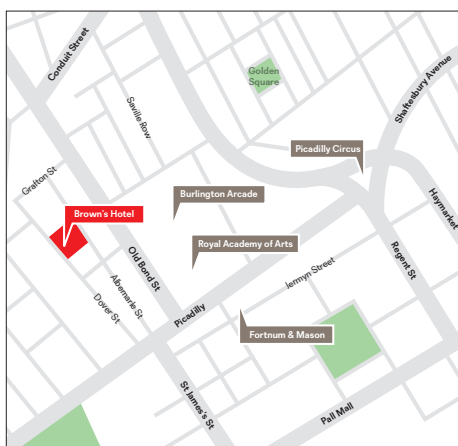

---

**Brown's Hotel**

Albemarle Street, London W1S 4BP, England  
T +44 20 7493 6020  
reservations.browns@roccofortehotels.com  
roccofortehotels.com/browns-hotel

BrownsHotelLondon  
 @Browns\_Hotel



# BROWN'S HOTEL

LONDON

A ROCCO FORTE HOTEL

	Size	Dimensions L x W x H	Boardroom/ Hollow Square	Cabaret	Classroom	Banqueting Rounds	Reception	Theatre	U-Shape	Wedding Service with aisle
<b>The Clarendon Room</b>	76m <sup>2</sup> 825ft <sup>2</sup>	11.3 x 6.7 x 3.4m 37' x 22' x 11'	20/20	35	30	70	120	70	30	80
<b>The Roosevelt Room</b>	52m <sup>2</sup> 568ft <sup>2</sup>	7.6 x 6.8 x 3.8m 25' x 22'8" x 19'9"	18/20	24	18	40	60	40	16	55
<b>The Niagara Room</b>	50m <sup>2</sup> 550ft <sup>2</sup>	7.6 x 6.7 x 3.8m 24'10" x 22'2" x 12'9"	21/18	18	18	30	60	40	14	50
<b>The Lord Byron Room</b>	30.2m <sup>2</sup> 328 ft <sup>2</sup>	5.6 x 5.3 x 3.3m 18'8" x 17'6" x 11'	12	-	12	-	16	10	-	-
<b>The Graham Bell Room</b>	21.8m <sup>2</sup> 234ft <sup>2</sup>	5.1 x 4.2 x 3.3m 17' x 13'10" x 11'	8	-	8	-	14	8	-	-
<b>The St George's Room</b>	20.8m <sup>2</sup> 224ft <sup>2</sup>	5.5 x 3.8m 18' x 12'4"	8	-	8	-	10	8	-	-

View of Dover Street

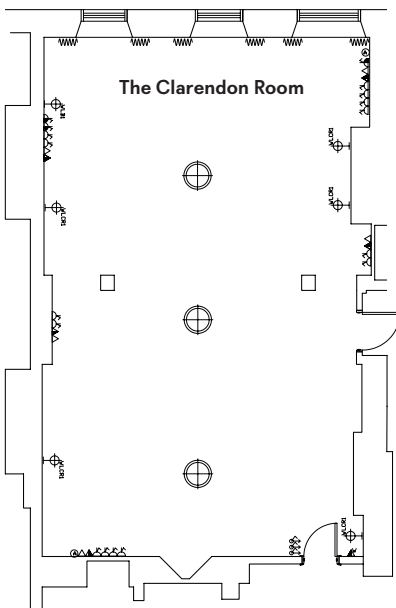

Ground Floor

View of Dover Street



Ground Floor

View of Dover Street

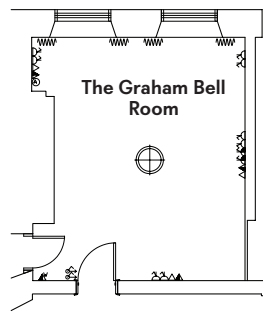

View of Dover Street

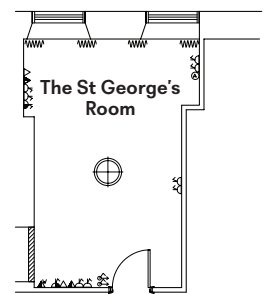

Ground Floor

First Floor

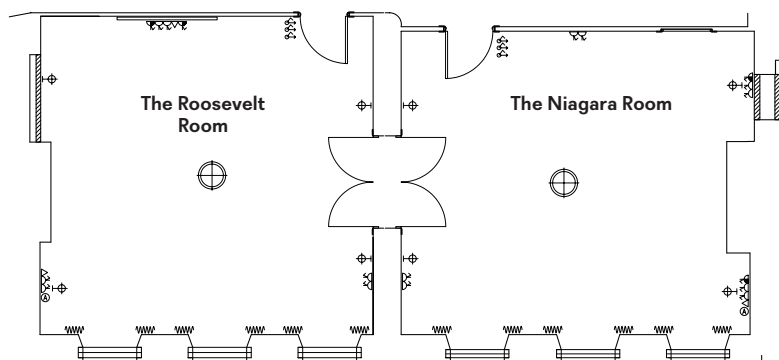

View of Albemarle Street